

Product Specifications

Name: 44-key Infrared Controller

Model: DR-CON-IR44B-3CH-LV(L=5,6,12,24)



Summarization

44-key infrared controller adopts the advanced micro control unit, it is used for controlling a variety of lamp whose source of light is LED. For instance, point source of light, flexible light strip, wall washer lamp, glass curtain wall light and so on; it has many advantages such as low price, easy connection and simplicity to use. Meanwhile, you could adjust brightness, static color choices and various dynamic changes in lighting effects through infrared remote control. Besides, you also could adjust random color by yourself freely.

Technical Parameters

- Working temperature: -20-60 °C
- Supply voltage: DC5V, 12V, 18V, 24V optional (specify the required voltage on orders)
- Output: 3 channels
- Connecting mode: common anode
- External dimension: L63XW35XH22 mm
- Controller dimension: L125XW56XH7mm
- Packing size: L130XW60XH35 mm
- Net weight: 60g
- Gross weight: 90 g
- Static power consumption: <1 W

DERUN LIGHTING TECHNOLOGY CO., LTD

- Output current: <2 A (each channel)
- Output power: 5V:<30W, 12V:<72W, 24V:<144W

External Dimension

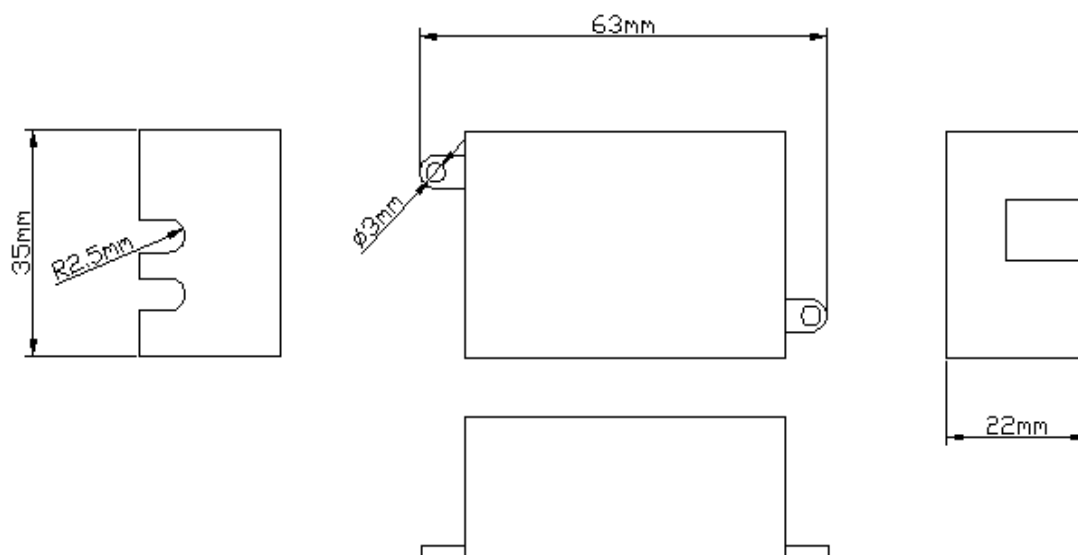

Interface Specifications

Power input interface:



Adopt conventional power Transposon as a DC power input interface.

Infrared receiver interface:



Adopt oblate three-way wire , and connect an infrared receiver to receive an external infrared.

Load output interface:



Adopt oblate interface.

DERUN LIGHTING TECHNOLOGY CO., LTD

Direction for use

1. Connect the load wire at first, following by the power wire; **Please ensure short circuit can not occur between connecting wire before you turn on the power;**
2. Operation: you will receive infrared remote control in front of infrared receiver to ensure that there is no barrier between the remote controller and receiver;

The key-press functions are shown in the table as below (in accordance with the key position order):

Brightness rise(a total of eight grading)	Brightness fall(a total of eight grading)	Pause/Run	On/Off
Static red	Static green	Static blue	Static white
Static orange	Static light green	Static dark blue	Static milk white
Static dark yellow	Static cyan	Static Lyons blue	Static white pink
Static yellow	Static light blue	Static purple	Static green-white
Static light yellow	Static sky blue	Static brown	Static blue white
Increase red	Increase green	Increase blue	Speed up
Decrease red	Decrease green	Decrease blue	Speed-down
DIY key1	DIY key2	DIY key3	Automatic change
DIY key4	DIY key5	DIY key6	Flash on and off
3 color jumpy change	7 color jumpy change	3 color fade change	7 color fade change

3. Complement explanation:

About DIY key, when it's pressed first time, will enter the DIY color mode, you can adjust the color per the 6 keys at above to increase or decrease the R/G/B color by yourself freely (if other key is pressed this time, will jump out from DIY color mode). And you can save the color which you have adjusted by pressing the DIY key once again. When next time this key is pressed, it will show the color you saved last time.

There are 6 DIY keys, so you can save 6 color you like. They are all Independent, have no effect each other. For example: if you press DIY key1 first, and then press DIY key2, DIY key1 will be invalid, until DIY key2 is pressed once again, current color will be saved.

DERUN LIGHTING TECHNOLOGY CO., LTD

Typical Applications

